

**Druckluftmotor**  
**Air motor**  
**Moteur à air comprimé**

**MRD 55-11000**  
**29906295**

**MANNESMANN**  
**DEMAG**

Nr. No.	BENENNUNG	DESCRIPTION	DESIGNATION	Lager-Nr. Stock-No. No. de magasin	STÜCK QUTY.
1	Flansch	flange	bride	48052 00 3	1
2	Dichtring	seal ring	anneau de joint	9321 904	1
3	Rillenkugellager	ball bearing	roulement à billes	9357 081	3
4	Distanzring	distance ring	entretoise	47405 00 3	2
5	Passfeder	feather key	clavette	9316 033	1
6	Mitnehmerwelle	drive shaft	broche d'entraînement	29802 92 3	1
7	Hülse	sleeve	douille	48055 00 3	1
8	Motorblock	motor cpl.	moteur cpl.	29800 97 5	1
8.1	Rillenkugellager	ball bearing	roulement à billes	9357 334	2
8.2	Spannstift	dowel pin	ergot	9335 220	1
8.3	Lagerschild vorne	end plate front	flasque de palier	47401 03 5	1
8.4	Rotor	rotor	rotor	29802 91 3	1
8.5	Lamelle	vane	palette	29303 42 6	4
8.6	Zylinder	cylinder	cylindre	47411 00 3	1
8.7	Lagerschild hinten	End plate rear	flasque de palier	47401 06 5	1
8.8	Spannstift	dowel	ergot	9335 219	1
9	Gehäuse	housing	carter	03135874	1
10	Luftinlass	air inlet	entrée d'air	29904 64 3	1
11	Verschlusschraube	locking screw	bouchon	9306 232	1

 70 Nm LH  
Loctite 243

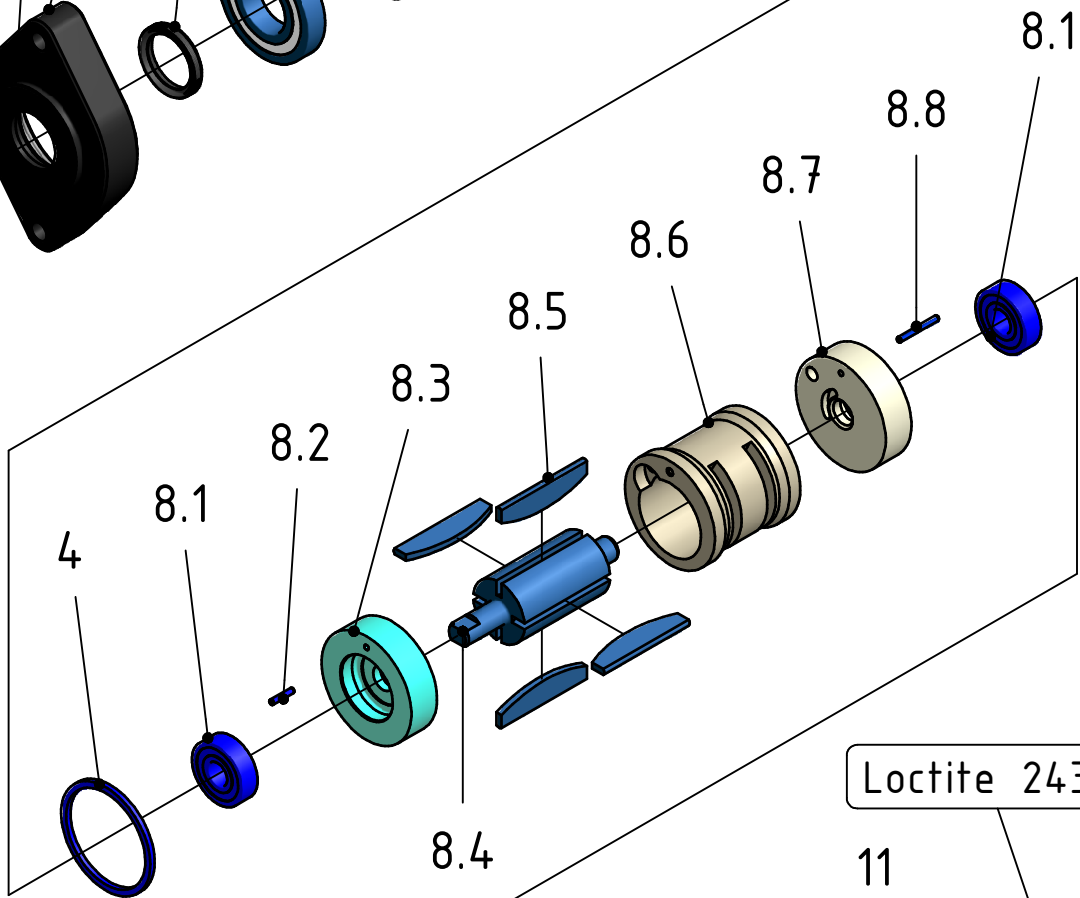
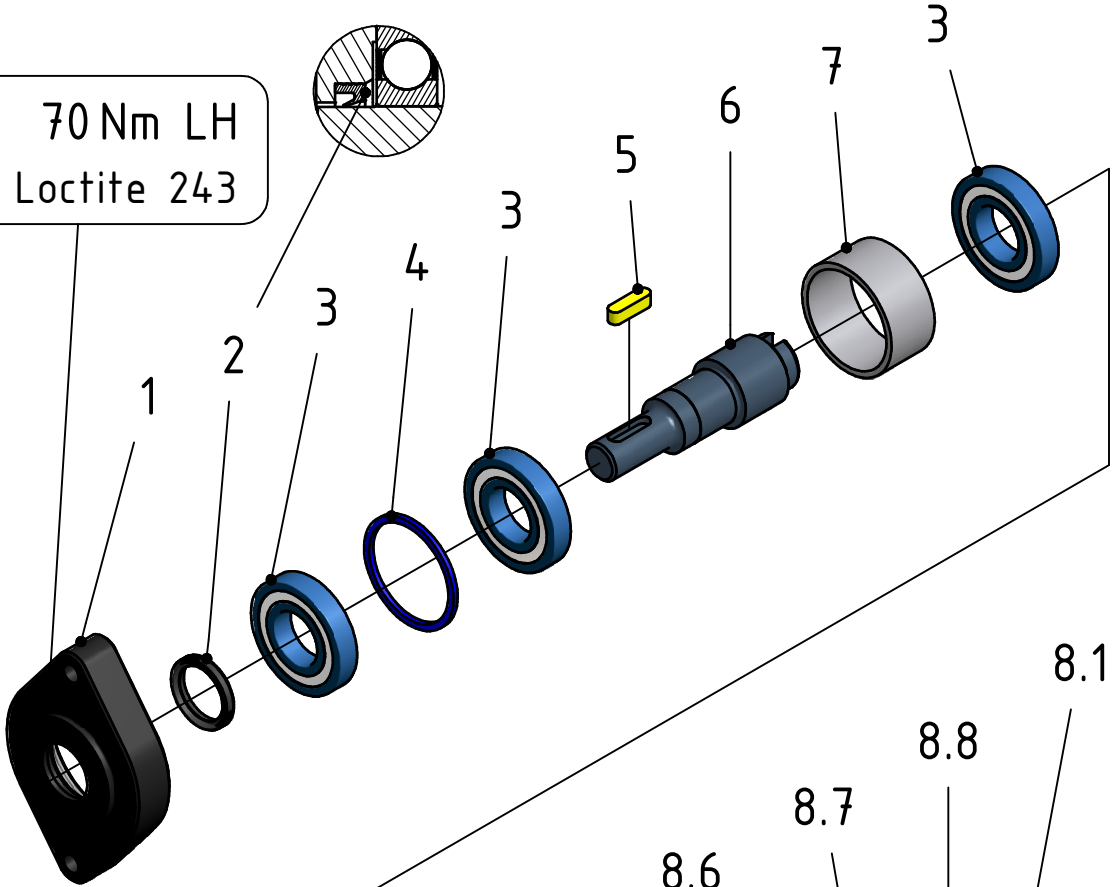

Loctite 243

MRD 55-11000  
29906295

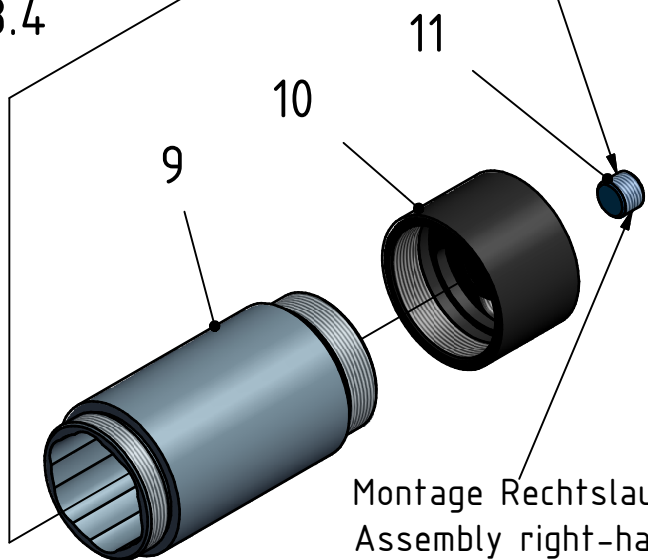

Montage Rechtslauf  
Assembly right-hand rotation