

**Druckluftmotor**  
**Air motor**  
**Moteur à air comprimé**

**MUD 23-190**  
**29910 83 7**

**MANNESMANN**  
**DEMAG**

| Nr.<br>No. | BENENNUNG               | DESCRIPTION                  | DESIGNATION                     | Lager-Nr.<br>Stock-No.<br>No. de magasin | STÜCK<br>QUTY. |
|------------|-------------------------|------------------------------|---------------------------------|--|----------------|
| 1          | Deckel                  | cover                        | couvercle                       | 29910997                                 | 1              |
| 2          | Dichtring               | seal ring                    | anneau de joint                 | 9321902                                  | 1              |
| 3          | Passfeder               | feather key                  | clavette                        | 9416016                                  | 1              |
| <b>4</b>   | <b>Planetengetriebe</b> | <b>planetary gearing</b>     | <b>engrenage planétaire</b>     | <b>29930647</b>                          | <b>1</b>       |
| 4.1        | Rillenkugellager        | ball bearing                 | roulement à billes              | 9357224                                  | 2              |
| 4.2        | Planetenradträger       | planetary carrier            | cage de transmission planétaire | 29930637                                 | 1              |
| 4.3        | Planetenrad             | planetary gear pinion        | roue planétaire                 | 29930373                                 | 2              |
| 4.4        | Lagernadel              | bearing needle               | aiguille de palier              | 9357205                                  | 32             |
| 4.5        | Lagernadel              | bearing needle               | aguille de palier               | 9357208                                  | 2              |
| 4.6        | Zahnkranz               | gear ring                    | couronne dentée                 | 29911107                                 | 1              |
| 5          | Tellerfeder             | Plate spring                 | Ressort belleville              | 9330807                                  | 1              |
| <b>6</b>   | <b>Planetengetriebe</b> | <b>planetary gearing</b>     | <b>engrenage planétaire</b>     | <b>29910945</b>                          | <b>1</b>       |
| 6.1        | Rillenkugellager        | ball bearing                 | roulement à billes              | 9357224                                  | 2              |
| 6.2        | Planetenradträger       | planetary carrier            | cage de transmission planétaire | 29911133                                 | 1              |
| 6.3        | Planetenrad             | planetary gear pinion        | roue planétaire                 | 29911143                                 | 2              |
| 6.4        | Nadelkranz              | needle roller and cage assen | cage à aiguilles                | 9357122                                  | 2              |
| 6.5        | Lagernadel              | bearing needle               | aiguille                        | 9357207                                  | 2              |
| 6.6        | Zahnkranz               | gear ring                    | couronne dentée                 | 29911077                                 | 1              |
| 7          | Beilagscheibe           | shim                         | rondelle de calage              | 29911003                                 | 1              |
| 8          | Gehäuse                 | housing                      | carter                          | 29911017                                 | 1              |
| <b>9</b>   | <b>Motorblock</b>       | <b>motor cpl.</b>            | <b>moteur cpl.</b>              | <b>29910905</b>                          | <b>1</b>       |
| 9.1        | Rillenkugellager        | ball bearing                 | roulement à billes              | 9357033                                  | 1              |
| 9.2        | Lagerschild vorne       | end plate front              | flasque de palier               | 29911193                                 | 1              |
| 9.3        | Spannstift              | dowel pin                    | ergot                           | 9335220                                  | 1              |
| 9.4        | Rotor                   | rotor                        | rotor                           | 29911233                                 | 1              |
| 9.5        | Lamelle                 | vane                         | palette                         | 29911186                                 | 5              |
| 9.6        | Zylinder                | cylinder                     | cylindre                        | 29911163                                 | 1              |
| 9.7        | Lagerschild hinten      | end plate rear               | flasque de palier               | 29911213                                 | 1              |
| 9.8        | Spannstift              | dowel pin                    | ergot                           | 9335216                                  | 1              |
| 9.9        | Rillenkugellager        | ball bearing                 | roulement à billes              | 9357046                                  | 1              |
| 10         | Lufteinlass             | air inlet                    | entrée d'air                    | 29911027                                 | 1              |
|            |                         |                              |                                 |  |                |

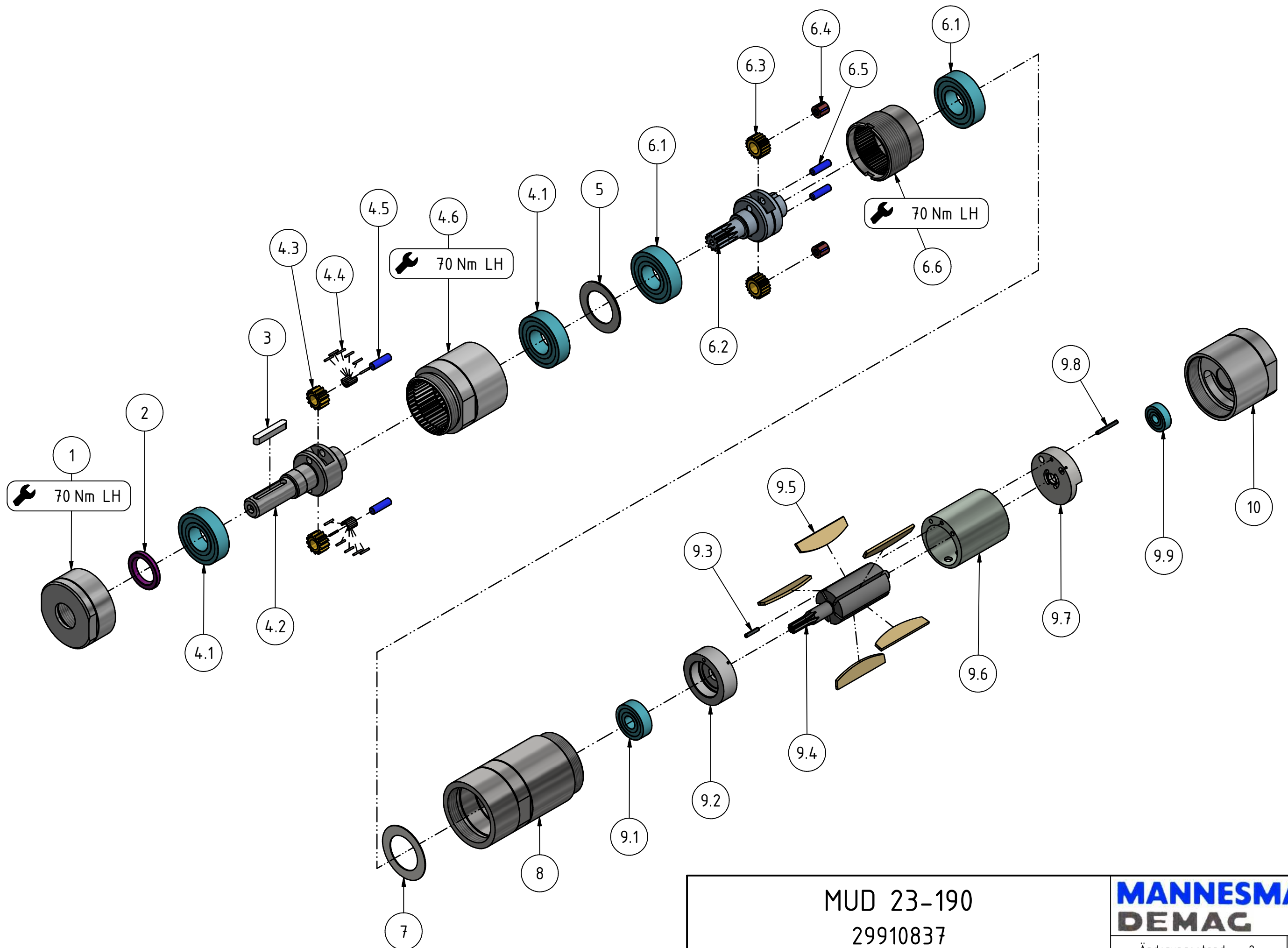

MUD 23-190  
 29910837

**MANNESMANN  
 DEMAG**

Änderungsstand: 2      22.07.2022